

Support for Doctoral Candidates and Postdocs at MARA



**Dr. Ines Braune, Dr. Karin Awe,
Dr. Christine Berger, Dr. Jan-Paul Klünder**
Marburg, April 30, 2024

Content

- What is MARA?
- MARA's workshop program
- Funding
- Consultation services
- Networking
- Further contacts at Philipps-Universität Marburg



MARburg University Research Academy (MARA) offers a wide range of support to junior scholars from the beginning of their doctorate to establishing their careers in an academic or non-academic field.

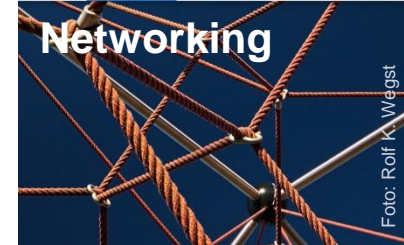

- ▶ Research practice
- ▶ Academic writing
- ▶ Academic communication
- ▶ Leadership and management
- ▶ Career planning and international issues
- ▶ Third-party funding and knowledge transfer

- ▶ Completion scholarships
- ▶ Travel assistance
- ▶ Conference organization
- ▶ Equal opportunity

- ▶ Individual consultation by MARA employees
- ▶ Coaching for advanced doctoral candidates and postdocs

- ▶ Academic groups, e.g. working groups of doctoral candidates
- ▶ PhD/Postdoc meeting
- ▶ Scientist's Day

www.uni-marburg.de/en/mara

Doctoral candidates Regardless of whether you are doing your doctorate with a scholarship, on a state or third-party-funded position, or part-time at Philipps-Universität Marburg, you are entitled to a membership at MARA.

- Required is the registration as a doctoral candidate in [MARVIN](#) and the approval of your self-registration by your department.

Postdocs If you are doing postdoctoral research at Philipps-Universität Marburg, then you are automatically a member of MARA.

- You count as a postdoc if you already hold your doctoral degree and have an employment contract at Philipps-Universität Marburg.

<https://www.uni-marburg.de/en/mara/institution/membership>

MARA Membership

DEUTSCH



MARburg University Research Academy – Members Area

Your Registration in the MARA database

In order to use the offers of MARA, please register once in our database with your personal data. Please fill out the form as completely as possible. Note that the fields marked with (*) are mandatory.

Formular

Personal information

Title

First name (*)

Surname (*)

E-mail (preferred) (*)

Gender (*)

- ☐ Male
☐ Female
☐ Divers

What is your nationality?

- ☐ German
☐ Other

We use this information to specifically address international members

Registration in the MARA database

- Use our services
- Get information on events and funding opportunities via e-mail distribution list

<https://www.tzm-marburg.de/mara-registrierung/antrag.cfm?lang=en>

MARA Workshop Program

Visit our [Calendar of Events](#)

Format

Online & in person

Language

German & English

Costs

Internal: 25 EUR/ course day

External: 75 EUR/ course day

Half-day courses free of charge

<u>Science, Private Economy or Public Administration? – Career Paths after Your Doctorate</u> Online event Registration until April 18, 2024	03.05.2024	14:00–18:00	D P A	Englis
<u>Social Media für die Wissenschaftskommunikation – Wie ich (meine) Forschung präsentieren kann</u> In-person event Registration until April 29, 2024	14.05.2024	9:00–17:00	D P A	Germa
<u>EMF – Management von Drittmittelprojekten</u> In-person event – FULLY BOOKED –	15.05.2024 16.05.2024	9:00–17:00 9:00–17:00	D P A	Germa

Program for Doctoral Candidates

Non-academic career

Academic career

Completion of doctorate

Support during doctorate

Preparation for doctoral studies

Contact Dr. Karin Awe karin.awe@uni-marburg.de

Program for Doctoral Candidates

Research Practice

R, Python, Good Scientific Practice, Research Data Management

Academic Writing

Writing Lab

Academic Communication

Presenting at Conferences, Academic Posters, How to Design Scientific Figures, Graphical Abstracts, Thesis-Defense Training

Leadership and Management

Project Management, Time- and Self Management

Career Planning and International Issues

Get That Job!, Career Paths after Your Doctorate

Academic Writing for the Humanities and Social Sciences / Life and Natural Sciences

Writing module

- Compact workshops
- Half-day workshops
- English academic writing
- Online writing retreat
- Exposé

Publishing module

- Publication process
- Writing for English-language publications

Individual writing consultation (in German only)

Postdoctoral Program of MARA



Certificate program EMF

Acquisition of competences for the acquisition and implementation of third-party funded projects



Communicating Academic Content

Bringing topics from your research to the public or a broader scientific community

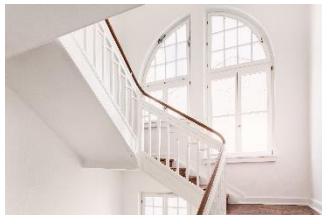

Career Development for Postdocs

Support on the way to a professorship and in the decision-making process

Other events

Further competences and career goals

Contact Dr. Christine Berger christine.berger@uni-marburg.de

Certificate program on the acquisition of competences for the development, application and management of third-party-funded projects

Module 1:
Project Design
and Project
Application



Module 2:
Project
Management



Module 3:
Presentation of
Third-Party-
Funded Projects



Module 4:
Transfer



Joint project with Universität Kassel

For doctoral candidates & postdocs (planning of application for funding)

Costs Registration fee 200 EUR + ~ 350 EUR for workshops

Highlight Reviewers Session & Acquisition of certificate

<https://www.uni-marburg.de/en/mara/emf>

Program Communicating Academic Content

Workshops

- The Basics of Science Communication
- Presenting Science to a (non-)Academic Audience
- Media and Interview Training
- Social Media
- Science Slam

Summer Schools

Coaching



www.uni-marburg.de/en/mara/wisskomm

Career Development for Postdocs

The program supports on the path to a professorship

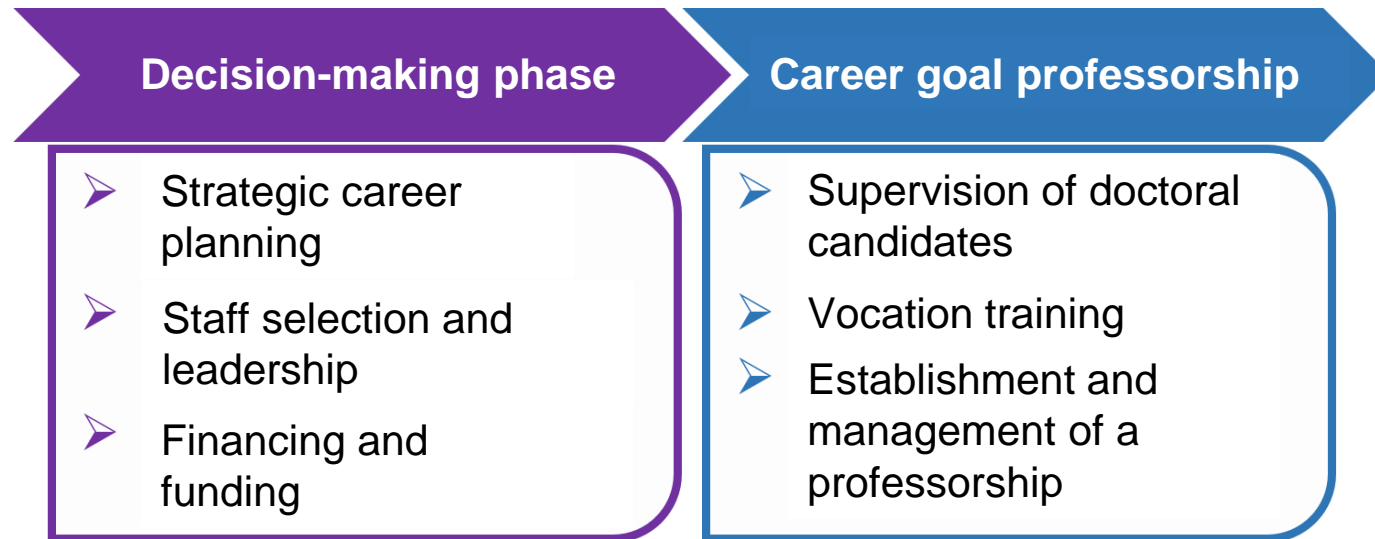

Joint project with Justus-Liebig-Universität Gießen

www.uni-marburg.de/en/mara/kfp

Postdoctoral program: Further offers

Workshops on current topics

Academic Writing

Academic Writing and AI

Leadership and Management

Academic Fixed-Term Contract Act, Committee Work

Career Planning and International Issues

Jobinterviewtraining, Career in Science Management and Administration

Funding Opportunities

- Completion scholarships
- Travel Assistance
- Conference Organization
- Equal Opportunity
- Student Assistant-Fund

The image shows two application forms from Philipps-Universität Marburg. The left form is titled 'Antrag auf Reisekostenbeihilfe durch die MARburg University Research Academy 20' and the right form is titled 'Antrag auf ein Promotionsstipendium der Philipps-Universität Marburg'. Both forms contain fields for personal and contact information.

Contact Dr. Jan-Paul Klünder

<https://www.uni-marburg.de/en/mara/funding>

Completion scholarships

- Annually for all disciplines
- For particularly qualified young academics who are completing their dissertations at the Philipps University of Marburg
- EUR 1,650 + EUR 100 material allowance, EUR 400 child allowance (1st child, additional children EUR 100 each)
- For **max.** 6 months
- Requirement: completion within the funding period, enrollment at a department at Philipps University and performance criteria

Travel Assistance for Doctoral Candidates and Postdocs

- Travel expenses/overnight stays/misc. costs
- **No** meal expenses/literature/travel to Germany
- For dissertation/research relevant travel

International travel

Travel to conferences (only for contributors)

Travel for academic collaboration with scientists

Field research (archive, library, monuments, etc.)

Domestic travel

Travel to national conferences (only if applicant is presenting)

Travel to international conferences (only if applicant is contributing)

- **Amount:** Per actual costs, up to 2,000 EUR, 1,500 EUR/trip
- **Timing:** Call for applications usually twice a year

Conference Organization

- For **organizing conferences** (conference-related costs, except for meal expenses, publishing costs, and fees for speakers from Marburg University)
- **No** meal costs, printing costs for publications and internal fees
- Up to **1,500 EUR** + 250 EUR childcare, per actual costs and available funds
- **Requirements:** For the purpose of funding Marburg doctoral candidates and postdocs, public events
- Applications all year, at least **3 months** prior to conference

Equal Opportunity

- **Full scholarships** for completion of habilitations (postdocs) for **6 months**
- **Outstanding female junior scholars**
Postdocs = 1,750 EUR + 103 EUR mat. + child allow.
- **Requirements:** Exceptional acad. quality, involvement in UMR, beginning in the current year
- **Applications possible all year round from 2025**

Student Assistant-Fund

- Philipps University doctoral and postdoctoral students with family responsibilities are eligible to apply **to finance a student assistant**.
- The support of a student assistant is funded at **20 hours per month for a maximum term of 6 months**.
- **Requirements:** doctoral candidates and postdocs with time-limited employment contracts and no own personnel funds + family obligations.
- Application deadline expected to be **early – late November 2024**

Consultation Services

- Individual consultation
- Coaching by external trainers
- Peer consultation



Contact

www.uni-marburg.de/en/mara/consultation-services

Individual Consultation

Personal one-on-one consultation on various subjects:

- Doctorate, yes or no?
- Financing your doctorate/postdoc phase
- MARA funding
- Career paths
- Skill acquisition
- Challenges and conflicts

Contact

Doctoral candidates (GSW)

Dr. Ines Braune

Doctoral candidates (LNW)

Dr. Karin Awe

Postdocs

Dr. Christine Berger, Dr. Ines Braune

MARA funding

Dr. Jan-Paul Klünder

www.uni-marburg.de/en/mara/consultation-services/individual-consultation

Coaching

Personal individual counseling with external coaches for advanced doctoral candidates and postdocs at Philipps-Universität Marburg, preferably in combination with a MARA workshop attended, in particular on the following topics:

- Career planning
- Review of third-party funding applications
- Scientific communication Lecture and
- Conference communication

MARA covers the costs of coaching (up to five 90-minute consultations)

Contact: Dr. Christine Berger

www.uni-marburg.de/de/mara/beratung/coaching

Peer Consultation

What is Peer Consultation?

- Consultation of a self-organized group with fixed roles and procedures

MARA will cover the costs for a coach to introduce a group of PhD students and postdocs of Philipps-Universität Marburg to peer consultation.

Contact Dr. Christine Berger

www.uni-marburg.de/en/mara/consultation-services/collegial-consultation

Networking

- Academic groups
- Scientists' Day
- Phd and Postdoc Meeting



Contact Dr. Ines Braune

www.uni-marburg.de/en/mara/networking

Self-organized interdisciplinary working groups under the umbrella of MARA with the following goals:

- Research-specific networking
- Interdisciplinary discussion of self-chosen topics
- Support of different formats

MARA makes their activities visible, supports with rooms, advertising and conference sponsorship

Informal application at any time to Dr. Ines Braune, Managing Director
www.uni-marburg.de/en/mara/networking/academic-groups

Scientists' Day

Annual information and networking day for early career researcher

- **2021:** Good Scientific Practice
- **2022:** Communicating Academic Content
- **2023:** Internationalization of career planning
- **2024:** Let AI do your research?!

on June 4, 2024 at Syn

Please register at vernetzung@uni-marburg.de by **May 15, 2024** at the latest. Participation is only possible with registration.

Organized by:

Vice President for Equal Opportunities and Career Development, Prof. Dr. Sabine Pankuweit, Department of Early Stage Researchers and MARA

www.uni-marburg.de/en/mara/networking

PhD and Postdoc Meeting

Annual university-wide information and networking day for early career researcher

- **2022:** Communicating Academic Content
- **2023:** Internationalization of career planning
- **2024: Use Artificial Intelligence!?**

Date: November 12, 2024

Organized by:

Vice President for Equal Opportunities and Career Development, Prof. Dr. Sabine Pankuweit, Department of Early Stage Researchers and MARA

www.uni-marburg.de/en/mara/networking

Further Contacts at Philipps-Universität

- Creative Space
- Representation of Doctoral Candidates
- Further Contact Points

Philipps



Universität
Marburg

Creative Space – Part of the XSpaces-initiative

The XSpaces are innovative, creative and interconnected workspaces. They support new forms of academic collaboration.

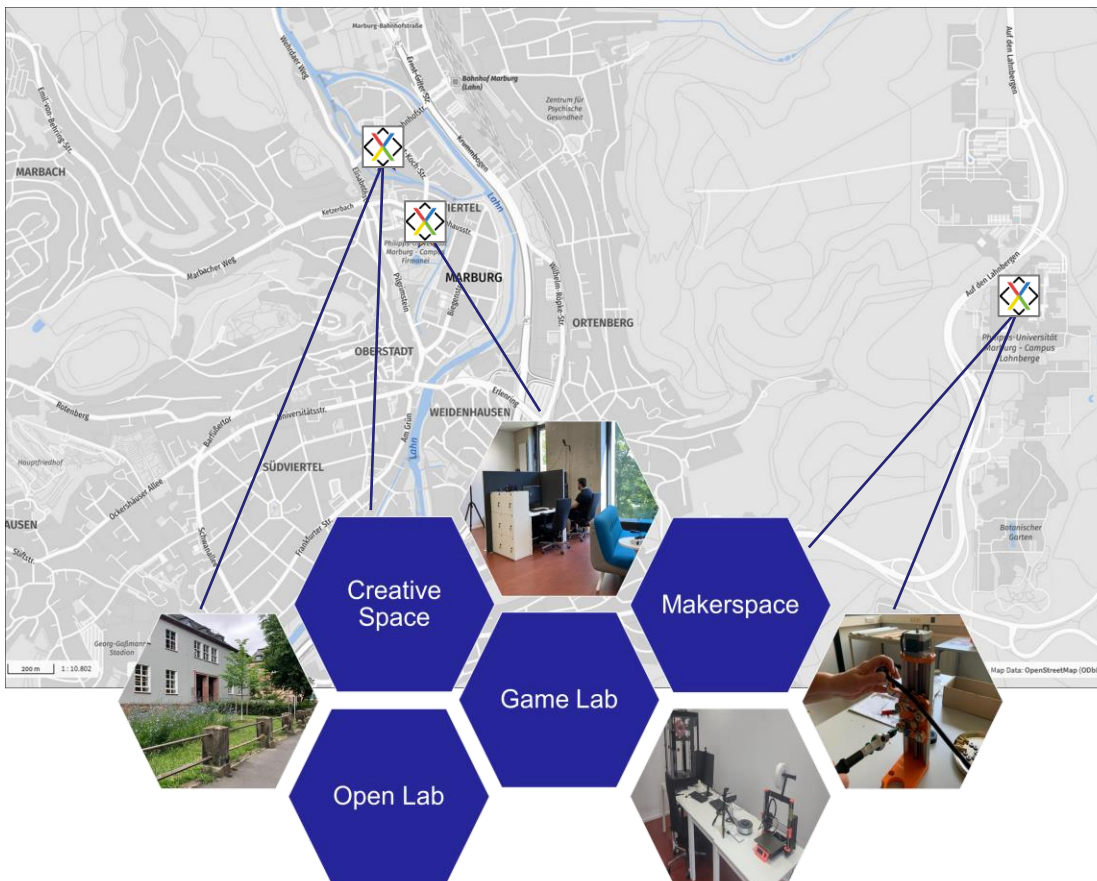

Makerspace:

The Makerspace is used for teaching and research as well as for start-up promotion. Working with 3-D data and printing is possible, as well as practical work with tools to create prototypes.

email: makerspace@uni-marburg.de

Game Lab:

The Game Lab offers game consoles (PS5, Xbox, Switch) and powerful workstations (Blender, Unity, etc.) as well as a VR area (HTC Vive, Pico Neo 3), augmented reality headsets and a stationary VR treadmill to view computer and video games, virtual reality apps and serious games and evaluate them for use in research and teaching.

email: medienzentrum@ub.uni-marburg.de

Open Lab:

In the Open Lab, there is a 3D scanner and 3D printer to make 3D scans of real or illustrative objects, model figures or technical prototypes. Opportunities for collaborative digital work are also offered with the help of an interactive touch display.

email: medienzentrum@ub.uni-marburg.de

Creative Space:

The Creative Space provides young academics with a space for creative project development, meetings, workshops, etc. Attractive rooms with flexible furniture and the technical infrastructure for creative collaboration promote new forms of academic collaboration.

email: creative-space@uni-marburg.de

Photos (f. l. t. r.):
View of the Creative Space in Bahnhofstraße (Photo: V. Benthin).
The Game Lab at the UB (Photo: J. Gaudron).
The Open Lab at the UB (Photo: M. Meinecke).
Makerspace: building a cutter (Photo: P. Kuhr).

Creative Space – „Club Behring“



A place for brainstorming. A space for network meetings, dialogue and project development. A place to get something off the ground together. An event space.

Creative Space – „Club Behring“

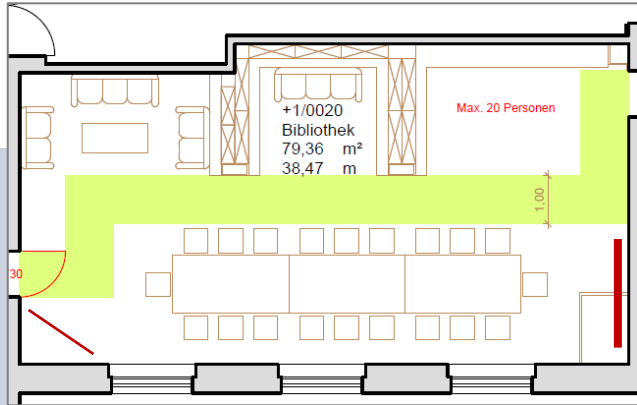

Setting 1: Workshop / Meeting (20 Pers.)

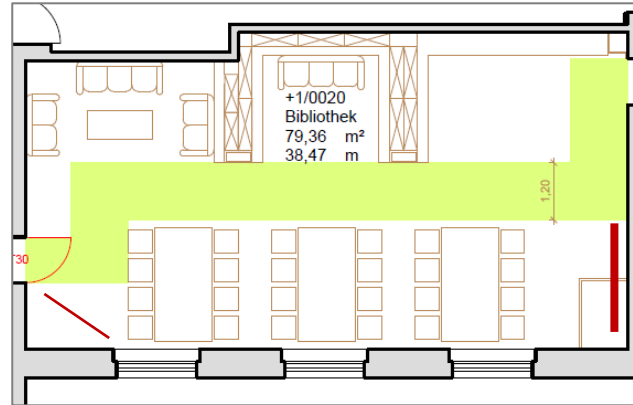

Setting 2: Workshop / 3 „working stations“ (21 Pers.)

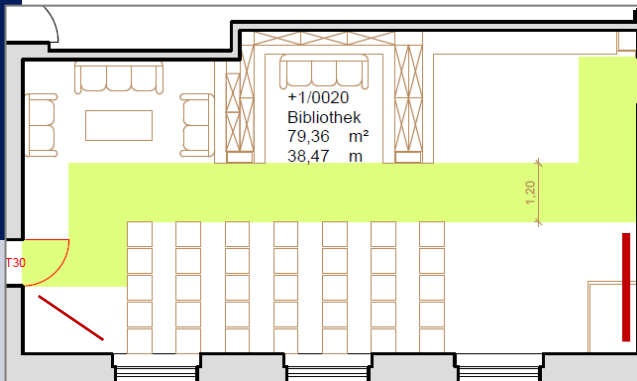

Setting 3: Lecture / Row Seating (35 Pers.)

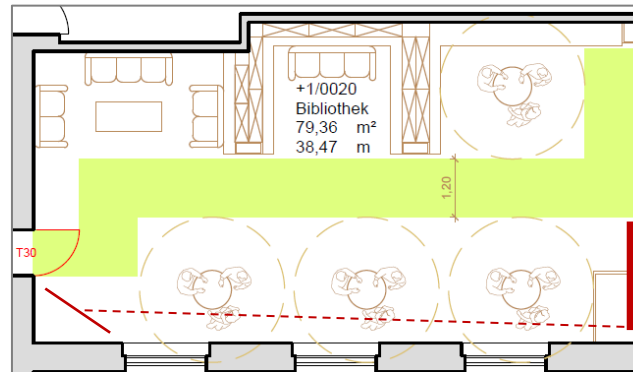

Setting 4: Reception with high tables (50 Pers.)

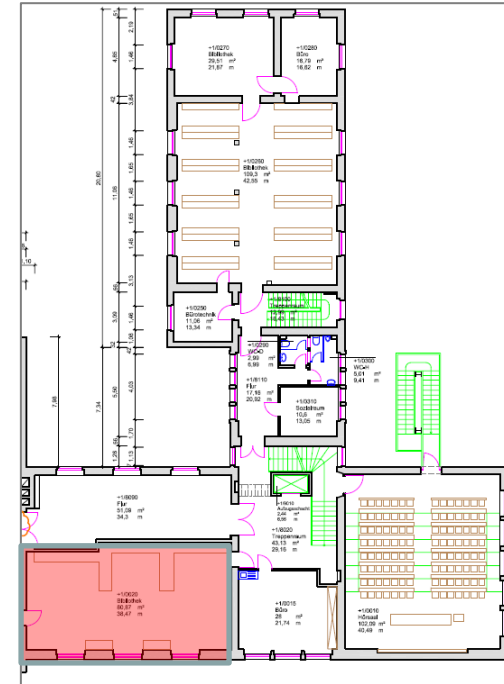

98" monitor + mounted 86" whiteboard for collaborative editing of files & documents, for hybrid working and presentations

Creative Space – „Club Behring“

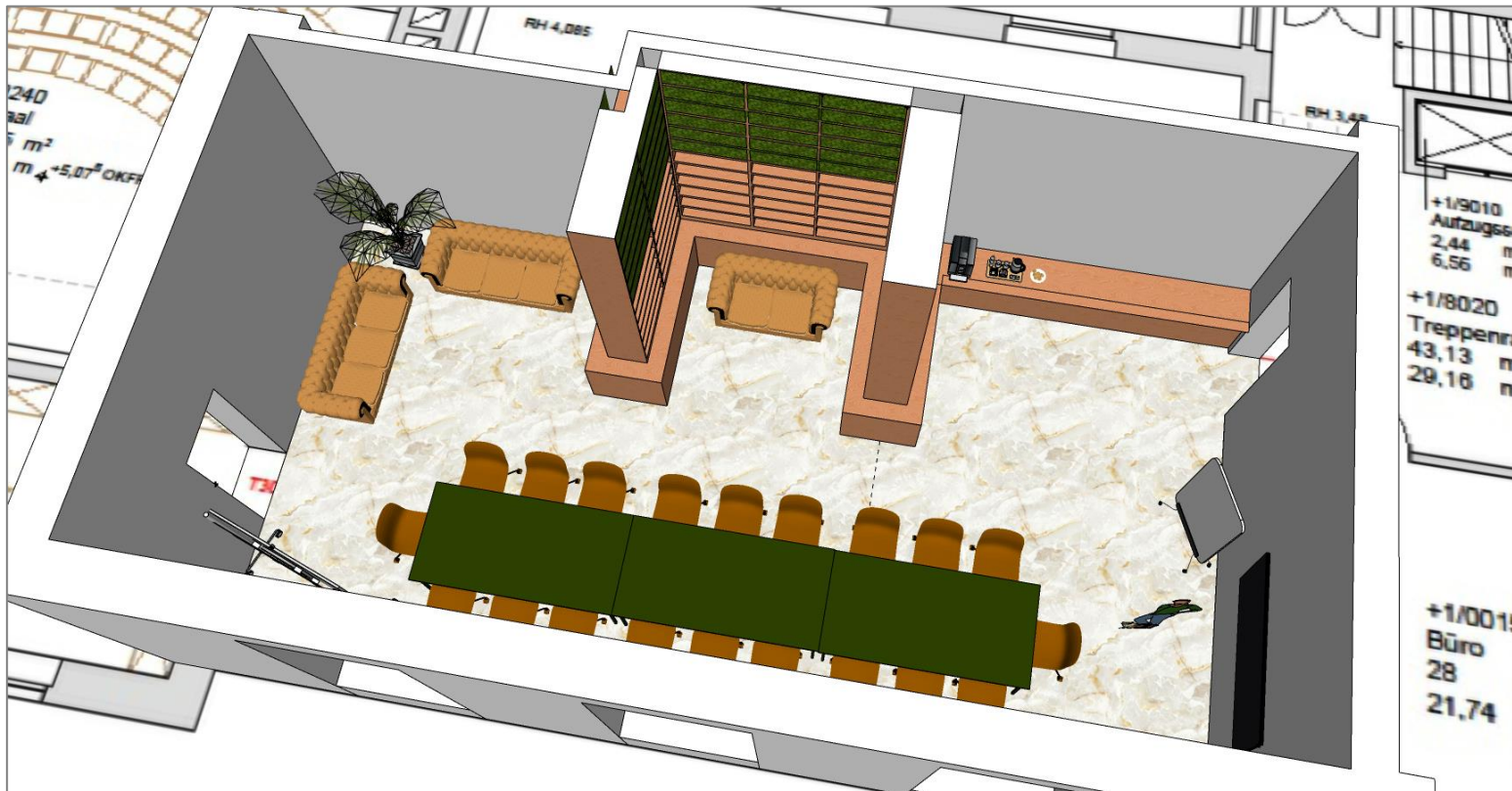

Visualisierung: S. Benthin

<https://www.uni-marburg.de/creative-space>

Booking calendar: <https://buchung-xspaces.uni-marburg.de/en-US/>

Email: creative-space@uni-marburg.de

Creative Space – Funding for (interdisciplinary) initiatives and for invitations of guest researchers

Through the Creative Space project, **phd candidates and postdocs** of Philipps-Universität Marburg can apply for funding for

a) (interdisciplinary) initiatives

b) invitations of guest researchers (Postdocs)

Each application can be funded with a maximum of 5000 €.

Who can apply?

Applications must be submitted by phd candidates and/or postdocs. For the application, **at least three applicants are required.** In order to promote interdisciplinarity, **several departments should be involved.** In order to ensure the funding of innovative initiatives, the topic must be new for the selected constellation of participants.

Further information:

<https://www.uni-marburg.de/en/research/young-academics/creative-space>

Representation of Doctoral Candidates

The elected doctoral candidates' representation of the Philipps-Universität Marburg organizes activities of doctoral candidates at Philipps-Universität Marburg, among others

- Meeting of doctoral candidates
- Regulars' table
- Colloquium
- Readers' meeting
- Dr. Sport

Email distribution list and contact

www.uni-marburg.de/de/forschung/talente/promovieren-in-marburg/wir-promovierenden-unter-uns/promovierendenvertretung

Further Interesting Contacts at Philipps-Universität

- Instruction Development and Teaching in Higher Education (Hochschuldidaktik)
- International Office
- Referat für Wissenschaftlichen Nachwuchs
- Equal Opportunities Office
- Language Center
- Human Resource Development (Personalentwicklung)



Next Dates

- 30.04.2024 Get to know the Creative Space
- 07.05.2024 Game Night im Creative Space
- 16.05.2024 Welcome Walk, 16 Uhr Mensa Lahnberge
- 04.06.2024 Tag der Wissenschaftler*innen „Let AI do your research!?“
- Visit the Calender of Events



...last but not least

Brochure:
"Why do a doctorate in Marburg?"

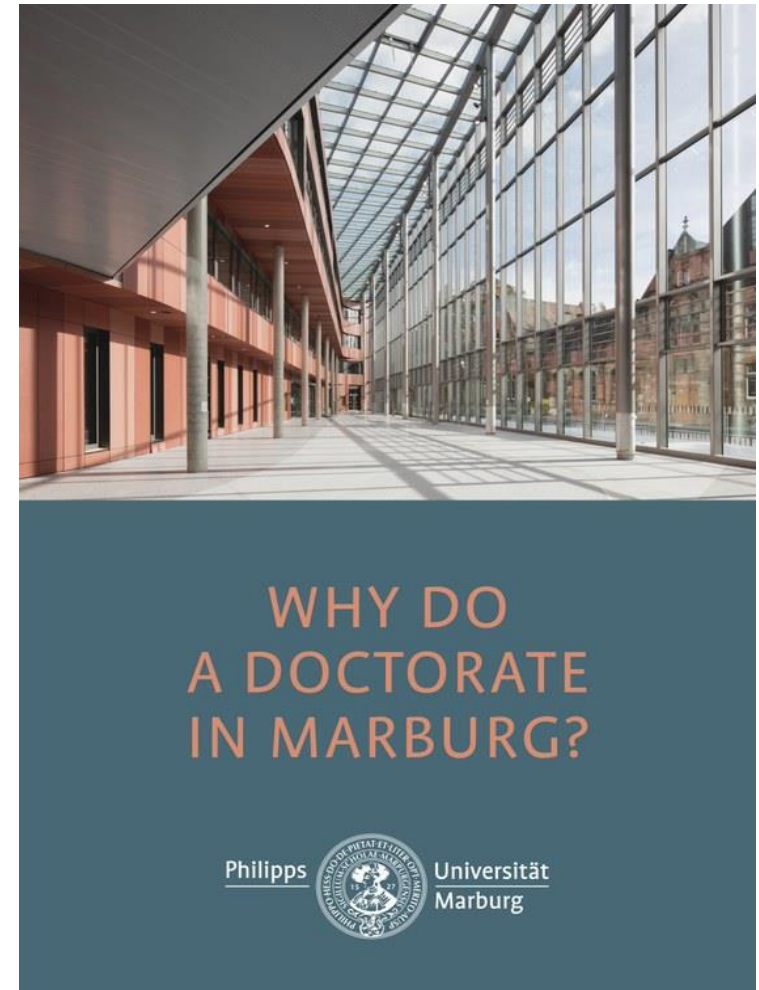

Thank you for your attention!

Managing Director

at MARA

Dr. Ines Braune

ines.braune@uni-marburg.de

Funding Opportunities

at MARA

Dr. Jan-Paul Klünder

jan-paul.kluender@uni-marburg.de

Program for Doctoral Candidates

at MARA

Dr. Karin Awe

karin.awe@uni-marburg.de

Postdoctoral Program

at MARA

Dr. Christine Berger

christine.berger@uni-marburg.de

www.uni-marburg.de/en/mara