

Support for Doctoral Candidates and Postdocs at MARA



**Dr. Ines Braune, Dr. Karin Awe,
Dr. Christine Berger, Dr. Jan-Paul Klünder**
Marburg, May 6, 2025

Content

- What is MARA?
- MARA's workshop program
- Funding
- Consultation services
- Networking
- Legal issues
- Further contacts at Philipps-Universität Marburg



MARburg University Research Academy (MARA) offers a wide range of support to early career researchers from the beginning of their doctorate to establishing their careers in an academic or non-academic field.



- Academic writing
- Academic communication
- Leadership and management
- Career planning and international issues
- Third-party funding and knowledge transfer



- Completion scholarships
- Travel assistance
- Conference organization
- Equal opportunity

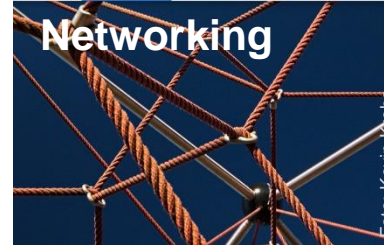

- Academic groups, e.g. working groups of doctoral candidates
- PhD/Postdoc meeting
- Scientist's Day
- Young Faculty Network
- Welcome Walk



- Individual consultation by MARA employees
- Coaching for advanced doctoral candidates and postdocs
- Individual writing consultation

www.uni-marburg.de/en/mara

Workshop Program

Visit our [Calendar of Events](#)

Extracurricular training

Format

Online & in person

Language

German & English

Costs

Half-day courses free of charge
Internal: 25 EUR/ course day

<u>Artificial Intelligence Tools – Responsible Use and Applications in Research and Academia</u> Online event Registration until May 2, 2025	16.05.2025	9:00–16:00	D P A	Engl
<u>Statistik-Crashkurs</u> In-person event – FULLY BOOKED –	19.05.2025 20.05.2025	9:00–16:00 9:00–16:00	D A	Gerr
<u>Good Scientific Practice – Protecting Research Integrity</u> Online event Registration until May 5, 2025	19.05.2025 20.05.2025	9:30–16:15 9:30–16:15	D A	Engl
<u>EMF – Management of Third-Party-Funded Research Projects</u>	20.05.2025 21.05.2025	9:00–15:30 9:00–15:30	D P A	Engl

MARA Database

DEUTSCH



MARburg University Research Academy – Members Area

Your Registration in the MARA database

In order to use the offers of MARA, please register once in our database with your personal data. Please fill out the form as completely as possible. Note that the fields marked with (*) are mandatory.

Formular

Personal information

Title

First name (*)

Surname (*)

E-mail (preferred) (*)

Gender (*)

- ☐ Male
☐ Female
☐ Divers

What is your nationality?

- ☐ German
☐ Other

We use this information to specifically address international members

Registration in the MARA database

- Use our services
- Get information on events and funding opportunities via e-mail distribution list

<https://www.tzm-marburg.de/mara-registrierung/antrag.cfm?lang=en>

Program for Doctoral Candidates

Non-academic career

Academic career

Completion of doctorate

Support during doctorate

Preparation for doctoral studies

Contact Dr. Karin Awe karin.awe@uni-marburg.de

Program for Doctoral Candidates – Writing Lab

Academic writing workshops tailored to the Humanities and Social Sciences & Life and Natural Sciences

➤ Writing module

- Writing your dissertation step by step
- Half-day workshops
- English academic writing
- Online writing retreat
- Exposé

➤ Publishing module

- Publication process
- Writing English-language publications

➤ Individual writing consultation

Program for Doctoral Candidates – Open Science

Methods and tools to help you keep your research process transparent and your results reproducible:

- Introduction to Research Data Management
- Statistical Data Analysis with R and Python
- Publishing Open Access
- Digital Humanities

www.uni-marburg.de/de/mara/veranstaltungen/programme-und-zertifikate/open-science

<https://www.uni-marburg.de/de/forschung/kontakt/ereseach/open-science>

Workshops for international doctoral candidates and postdocs

- Proportion of English-language events in 2024: 40%
- Events specifically designed for doctoral candidates and postdocs from abroad:
 - [How to Get into the Non-Academic German Job Market](#) (26./27.03.2025)
 - [Finding Your Way at the University of Marburg! How to Settle in, Feel at Home and Thrive at Work – A Workshop for International Researchers](#) (24./25.11.2025)

Postdoctoral Program of MARA



Certificate program EMF

Acquisition of competences for the acquisition and implementation of third-party funded projects



Communicating Academic Content

Bringing topics from your research to the public or a broader scientific community

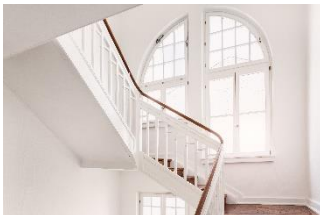

Career Development for Postdocs

Support on the way to a professorship and in the decision-making process

Other events

Further competences and career goals

Contact Dr. Christine Berger christine.berger@uni-marburg.de

Certificate program on the acquisition of competences for the development, application and management of third-party-funded projects

Module 1:
Project Design
and Project
Application



Module 2:
Project
Management



Module 3:
Presentation of
Third-Party-
Funded Projects



Module 4:
Transfer



Joint project with Universität Kassel

For doctoral candidates & postdocs (planning of application for funding)

Costs Registration fee 200 EUR + ~ 350 EUR for workshops

Highlight Reviewers Session & Acquisition of certificate

<https://www.uni-marburg.de/en/mara/emf>

Info events
in Nov

Program Communicating Academic Content

Workshops

- The Basics of Science Communication
- Presenting Science to a (non-)Academic Audience
- Media and Interview Training
- Social Media
- Science Slam

Summer Schools

Coaching



www.uni-marburg.de/en/mara/wisskomm

Career Development for Postdocs

The program supports on the path to a professorship

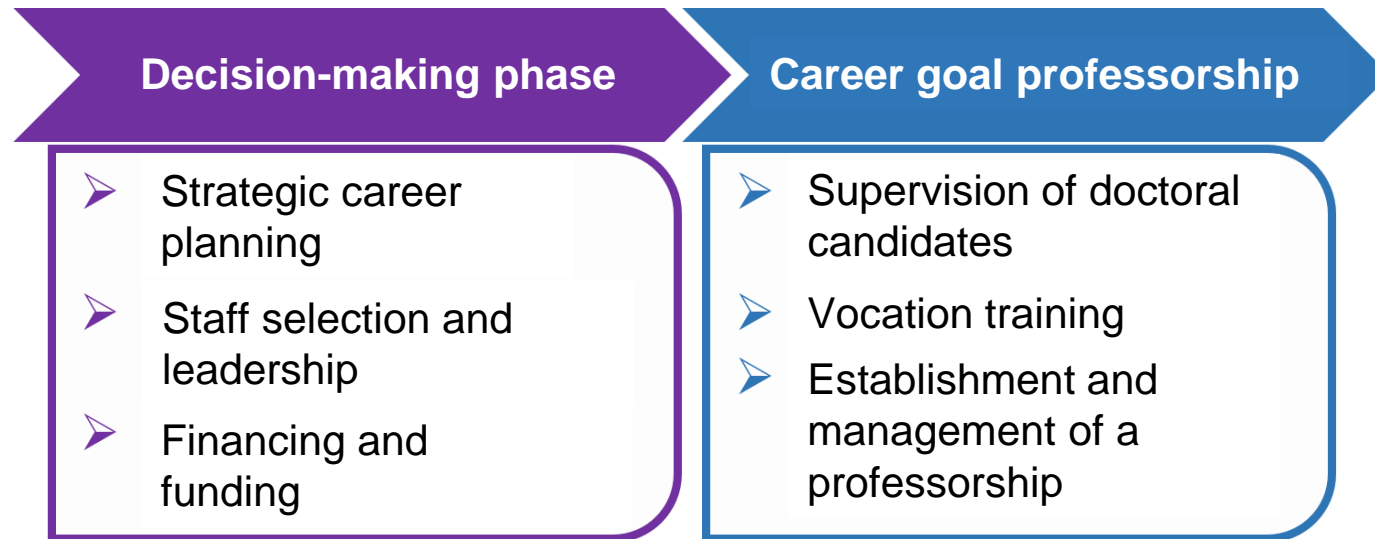

Joint project with Justus-Liebig-Universität Gießen

www.uni-marburg.de/en/mara/kfp

Postdoctoral program: Further offers

Workshops on current topics

Leadership and Management

Academic Fixed-Term Contract Act, Committee Work

Career Planning and International Issues

Career in Science Management and Administration

Funding Opportunities

- Travel Assistance
- Conference Organization
- Completion scholarships
- Equal Opportunity
- Student Assistant-Fund

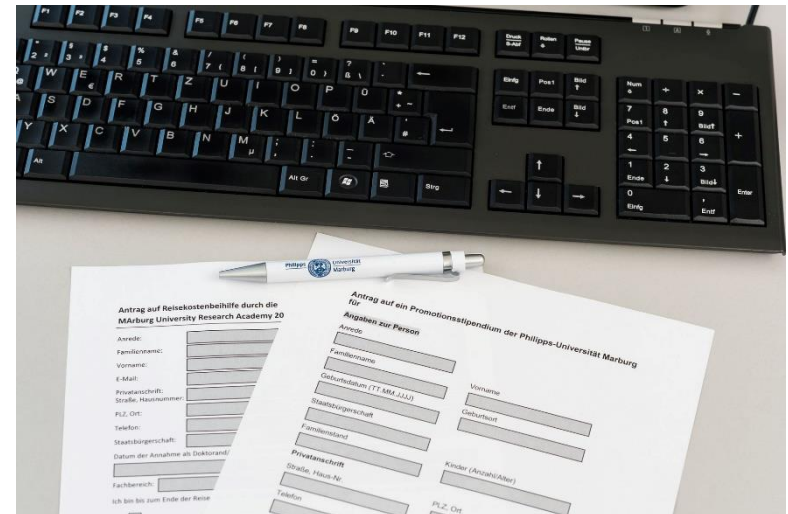

Contact Dr. Jan-Paul Klünder

<https://www.uni-marburg.de/en/mara/funding>

Travel Assistance for Doctoral Candidates and Postdocs

- Travel expenses/overnight stays/misc. costs
- **No** meal expenses/literature/travel to Germany
- For dissertation/research relevant travel

International travel

Travel to conferences (only for contributors)
Travel for academic collaboration with scientists
Field research (archive, library, monuments, etc.)

Domestic travel

Travel to national conferences (only if applicant is presenting)
Travel to international conferences (only if applicant is contributing)
Field research (archive, library, monuments, etc.)

- **Amount:** Per actual costs, up to 2,000 EUR, 1,500 EUR/trip
- **Timing:** Call for applications usually twice a year

Conference Organization

- For **organizing conferences** (conference-related costs)
- **No** meal costs, printing costs for publications and internal fees
- Up to **1,500 EUR** + 250 EUR childcare, per actual costs and available funds
- **Requirements:** For the purpose of funding Marburg doctoral candidates and postdocs, public events
- Applications all year, at least **3 months** prior to conference

Completion scholarships

- Annually for all disciplines
- For particularly qualified academics who are completing their dissertations at the Philipps University of Marburg
- EUR 1,650 + EUR 100 material allowance, EUR 400 child allowance (1st child, additional children EUR 100 each)
- For **max.** 6 months
- Requirement: completion within the funding period, enrollment at a department at Philipps University and performance criteria

Equal Opportunity

- **Full scholarships** for completion of habilitations (postdocs) for **6 months**
- **Outstanding female junior scholars**
Postdocs = 1,750 EUR + 103 EUR mat. + child allow.
- **Requirements:** Exceptional acad. quality, involvement in UMR, beginning in the current year
- **Applications possible all year round from 2025**

Student Assistant-Fund

- Philipps University doctoral and postdoctoral students with family responsibilities are eligible to apply **to finance a student assistant**.
- The support of a student assistant is funded at **20 hours per month for a maximum term of 6 months**.
- **Requirements:** doctoral candidates and postdocs with time-limited employment contracts and no own personnel funds + family obligations.
- Application deadline expected to be **late November 2025**

Consultation Services

- Individual consultation
- Coaching by external trainers
- Peer consultation



Contact

www.uni-marburg.de/en/mara/consultation-services

Individual Consultation

Personal one-on-one consultation on various subjects:

- Doctorate, yes or no?
- Financing your doctorate/postdoc phase
- MARA funding
- Career paths
- Skill acquisition
- Challenges and conflicts

Contact

Doctoral candidates (GSW)

Dr. Ines Braune

Doctoral candidates (LNW)

Dr. Karin Awe

Postdocs

Dr. Christine Berger, Dr. Ines Braune

MARA funding

Dr. Jan-Paul Klünder

www.uni-marburg.de/en/mara/consultation-services/individual-consultation

Coaching

Personal individual counseling with external coaches for advanced doctoral candidates and postdocs at Philipps-Universität Marburg, preferably in combination with a MARA workshop attended, in particular on the following topics:

- Career planning
- Review of third-party funding applications
- Scientific communication Lecture and
- Conference communication

MARA covers the costs of coaching (up to five 90-minute consultations)

Contact: Dr. Christine Berger

www.uni-marburg.de/de/mara/beratung/coaching

Networking

- Scientists' Day
- Phd and Postdoc Meeting
- Welcome Walk



Contact Dr. Ines Braune
www.uni-marburg.de/en/mara/networking

Scientists' Day

Annual information and networking day for early career researcher

- **2021:** Good Scientific Practice
- **2022:** Communicating Academic Content
- **2023:** Internationalization of career planning
- **2024:** Let AI do your research?!
- **2025:** Creativity and innovation: thinking forward!

Date: July 22, 2025

Organized by:

Vice President for Equal Opportunities and Career Development, Prof. Dr. Sabine Pankuweit, Department of Early Stage Researchers and MARA

www.uni-marburg.de/en/mara/networking

PhD and Postdoc Meeting

Annual university-wide information and networking day for early career researcher

- **2022:** Communicating Academic Content
- **2023:** Internationalization of career planning
- **2024:** Use Artificial Intelligence!?
- **2025: Creativity and Innovation: „Future Skills“**

Date: November 05, 2025

Organized by:

Vice President for Equal Opportunities and Career Development, Prof. Dr. Sabine Pankuweit, Department of Early Stage Researchers and MARA

www.uni-marburg.de/en/mara/networking

Welcome Walk

New or curious?
Get to know new people and tips...
walking in the Lahntal and on the Lahnberge.

Welcome Run

May 21, 12-1 p.m.
University Stadium

May 22, 4-6 p.m.
Mensa Lahnberge

- >German and English
- >four times a year, 2 hours
- >Important information
- >Networking



Doctoral candidates Regardless of whether you are doing your doctorate with a scholarship, on a state or third-party-funded position, or part-time at Philipps-Universität Marburg, you are entitled to take advantage of the MARA services.

- Required is the registration as a doctoral candidate in [MARVIN](#) and the approval of your self-registration by your department.

Postdocs If you are doing postdoctoral research at Philipps-Universität Marburg, then you are automatically a member of MARA.

- You count as a postdoc if you finished your disputation and have an employment contract at Philipps-Universität Marburg.

<https://www.uni-marburg.de/en/mara/institution/membership>

1. Self-registration with MARVIN
(Registration or enrollment as doctoral candidate)
2. Acceptance as a doctoral student at the department
3. Department confirms registration with MARVIN

You are doing your doctorate at a department! You have rights!

-Promotionsordnung
Doctoral Degree Regulations

-Promotionsausschuss
Doctoral Degree Committee

Der Fachbereichsrat des Fachbereichs Fremdsprachliche Philologien der Philipps-Universität Marburg beschließt gemäß § 50 Abs. 1 HHG in der Fassung vom 05.11.2007 (GVBl. I S. 710) folgende Ordnung:

Promotionsordnung
des Fachbereichs Fremdsprachliche Philologien
der Philipps-Universität Marburg
vom 02.12.2009

Inhaltsverzeichnis:

- § 1 Anwendungsbereich und Ziele
- § 2 Promotion und Doktorgrad
- § 3 Promotionsausschuss
- § 4 Prüfungskommission
- § 5 Annahme als Doktorandin oder Doktorand
- § 6 Betreuung der Dissertation
 - * Die Dissertation
 - * kumulative Dissertation

Further Contacts at Philipps-Universität

- Brochure: Why do a Doctorate in Marburg?
- Creative Space
- Representation of Doctoral Candidates
- Further Contact Points

Philipps



Universität
Marburg

Brochure

Brochure: "Why do a Doctorate in Marburg?"

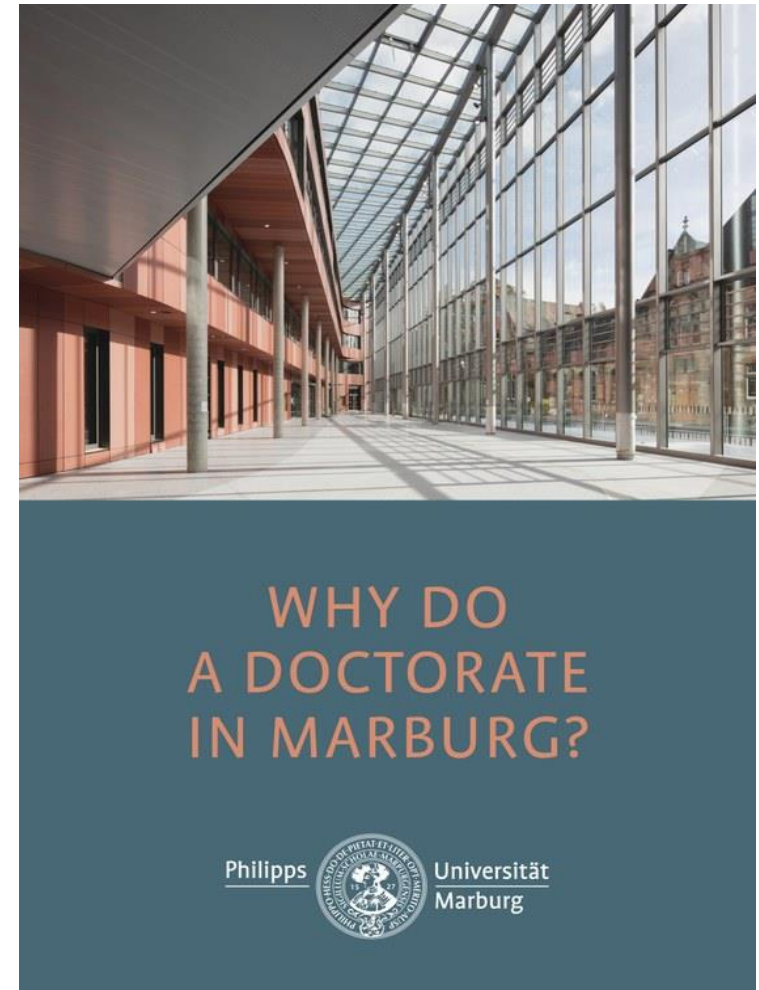

Creative Space – Part of the XSpaces-initiative

The XSpaces are innovative, creative and interconnected workspaces. They support new forms of academic collaboration.



Makerspace:

The Makerspace is used for teaching and research as well as for start-up promotion. Working with 3-D data and printing is possible, as well as practical work with tools to create prototypes.

email: makerspace@uni-marburg.de

Game Lab:

The Game Lab offers game consoles (PS5, Xbox, Switch) and powerful workstations (Blender, Unity, etc.) as well as a VR area (HTC Vive, Pico Neo 3), augmented reality headsets and a stationary VR treadmill to view computer and video games, virtual reality apps and serious games and evaluate them for use in research and teaching.

email: medienzentrum@ub.uni-marburg.de

Open Lab:

In the Open Lab, there is a 3D scanner and 3D printer to make 3D scans of real or illustrative objects, model figures or technical prototypes. Opportunities for collaborative digital work are also offered with the help of an interactive touch display.

email: medienzentrum@ub.uni-marburg.de

Creative Space:

The Creative Space provides young academics with a space for creative project development, meetings, workshops, etc. Attractive rooms with flexible furniture and the technical infrastructure for creative collaboration promote new forms of academic collaboration.

email: creative-space@uni-marburg.de

Photos (f. l. t. r.):
View of the Creative Space in Bahnhofstraße (Photo: V. Benthin).
The Game Lab at the UB (Photo: J. Gaudron).
The Open Lab at the UB (Photo: M. Meinecke).
Makerspace: building a cutter (Photo: P. Kuhr).

What is project Creative Space about?

Space

- Establishment of a creative center, especially for young scientists
- Attractive rooms with flexible furnishings as well as technical and analogue infrastructure for creative collaboration
- Interdisciplinary meeting place and project exchange

Funding

- Allocation of funding to doctoral candidates and postdocs for interdisciplinary initiatives and for invitations to visiting scholars
- Up to 5000 € / application for the implementation of innovative ideas in the fields of science, science policy, science communication or transfer

Conceptual support

- Design Thinking
- Creative project development
- Conceptual advice on event formats
- Support by moderation of events

Goals:

- Strengthening the early independence and the individual academic profile of early stage researchers
- Promotion of interdisciplinary cooperation and networking
- Supporting the successful development of projects and applications as well as the organisation of events

Creative Space – Room for ideas



A place for brainstorming. A space for network meetings, dialogue and project development. A place to get something off the ground together. An event space.

Creative Space – „Club Behring“

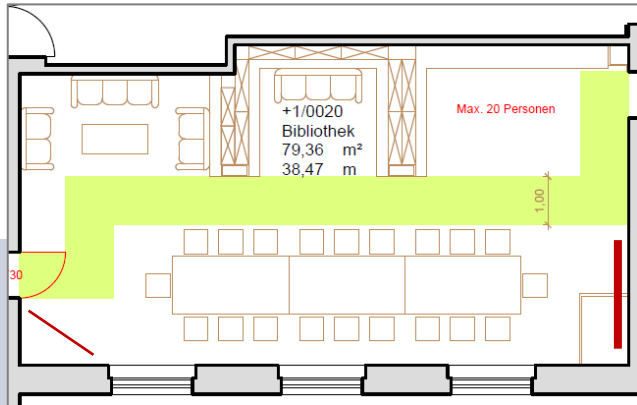

Setting 1: Workshop / Meeting (20 Pers.)

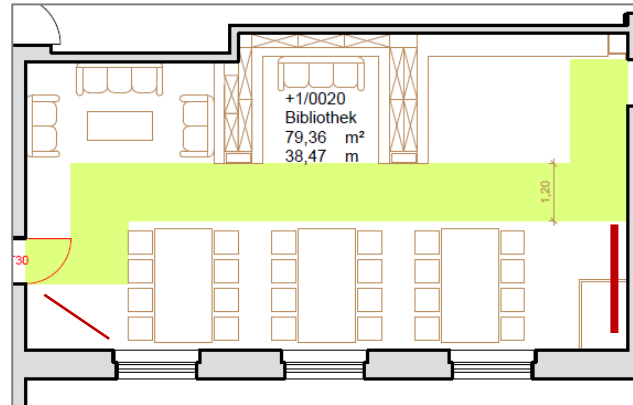

Setting 2: Workshop / 3 „working stations“ (21 Pers.)

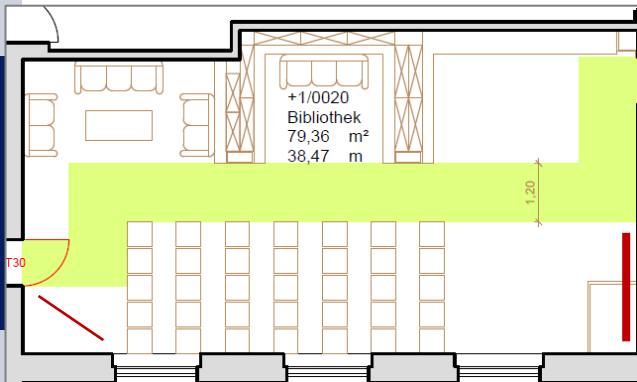

Setting 3: Lecture / Row Seating (35 Pers.)

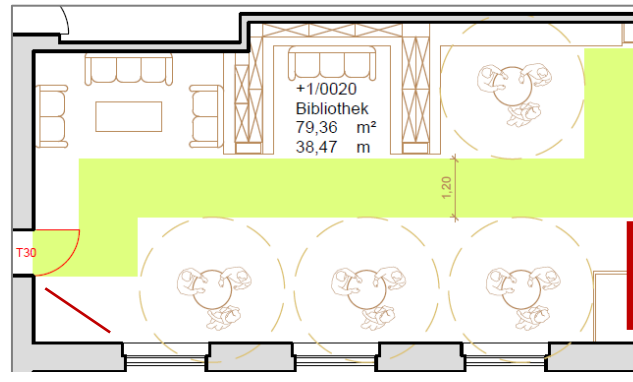

Setting 4: Reception with high tables (50 Pers.)

Equipment:

- 98" monitor for presentations
- 86" Clevertouch monitor for collaborative editing of documents, as a whiteboard, for hybrid working, video conferencing
- 3 movable work walls as presentation walls, pin boards, memo boards etc.
- Moderation case
- Video conferencing system with camera and table microphones
- Second webcam with integrated microphone and 2 headsets for hosting online events
- Remote control/presenter for presentations
- USB-C adapter, mini display port adapter
- Coffee/tea station

Creative Space – Funding for (interdisciplinary) initiatives and for invitations of guest researchers

Through the Creative Space project, **phd candidates and postdocs** of Philipps-Universität Marburg can apply for funding for

a) (interdisciplinary) initiatives

b) invitations of guest researchers (Postdocs)

Each application can be funded with a maximum of 5000 €.

Who can apply?

Applications must be submitted by phd candidates and/or postdocs. For the application, **at least three applicants are required.** In order to promote interdisciplinarity, **several departments should be involved.** In order to ensure the funding of innovative initiatives, the topic must be new for the selected constellation of participants.

Further information:

<https://www.uni-marburg.de/en/research/young-academics/creative-space>

Creative Space

Website: <https://www.uni-marburg.de/creative-space>

Kontakt: creative-space@uni-marburg.de

Booking calendar: <https://buchung-xspaces.uni-marburg.de/en-US/>

Follow us on Instagram

Info, insights, news:

Scan the QR code and follow the Creative Space project:



Representation of Doctoral Candidates

The elected doctoral candidates' representation of the Philipps-Universität Marburg organizes activities of doctoral candidates at Philipps-Universität Marburg, among others

- Meeting of doctoral candidates
- Regulars' table
- Colloquium
- Readers' meeting
- Dr. Sport

Email distribution list and contact

www.uni-marburg.de/de/forschung/talente/promovieren-in-marburg/wir-promovierenden-unter-uns/promovierendenvertretung

Further Interesting Contacts at Philipps-Universität

- Instruction Development and Teaching in Higher Education (Hochschuldidaktik)
- International Office
- Referat für Wissenschaftlichen Nachwuchs
- Equal Opportunities Office
- Language Center
- Human Resource Development (Personalentwicklung)



Next Dates

- May 16, Info event: Funding opportunities in the Creative Space project
- May 19/20, Good Scientific Practice, Online Event
- May 21, Welcome Run, University Stadium
- May 22, Welcome Walk, Mensa Lahnberge
- Visit the Calender of Events



Thank you for your attention!

Managing Director

at MARA

Dr. Ines Braune

ines.braune@uni-marburg.de

Funding Opportunities

at MARA

Dr. Jan-Paul Klünder

jan-paul.kluender@uni-marburg.de

Program for Doctoral Candidates

at MARA

Dr. Karin Awe

karin.awe@uni-marburg.de

Postdoctoral Program

at MARA

Dr. Christine Berger

christine.berger@uni-marburg.de

www.uni-marburg.de/en/mara