



**Marburg  
University**

# Support for Doctoral Candidates and Postdocs at MARA



**Dr. Ines Braune, Dr. Karin Awe,  
Dr. Christine Berger, Dr. Jan-Paul Klünder**  
Marburg, April 21, 2026

# Content

- What is MARA?
- MARA's workshop program
- Funding
- Consultation services
- Networking
- Legal issues
- Further contacts at Philipps-Universität Marburg



MARburg University Research Academy (MARA) offers a wide range of support to early career researchers from the beginning of their doctorate to establishing their careers in an academic or non-academic field.

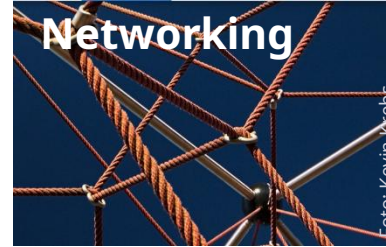

- ▶ Academic writing
- ▶ Academic communication
- ▶ Leadership and management
- ▶ Career planning and international issues
- ▶ Third-party funding and knowledge transfer

- ▶ Travel assistance
- ▶ Conference organization
- ▶ Completion scholarships
- ▶ Equal opportunity

- ▶ Academic groups, e.g. working groups of doctoral candidates
- ▶ PhD/Postdoc meeting
- ▶ Scientists' Day
- ▶ Young Faculty Network
- ▶ Welcome Walk

- ▶ Individual consultation by MARA employees
- ▶ Coaching for advanced doctoral candidates and postdocs

[www.uni-marburg.de/en/mara](http://www.uni-marburg.de/en/mara)

# Workshop Program

Visit our [Calendar of Events](#)

## Extracurricular training

### Format

Online & in-person

### Language

German & English

### Attendance fee

25 EUR / course day

Half-day courses free of charge

Artificial Intelligence Tools – Responsible Use and Applications in Research and Academia  
Online event  
Registration until April 15, 2026

30.04.2026

9:00–16:00

English

EMF – Bewertung, Schutz und Vermarktung von Hochschul-Know-how  
In-person event  
Registration until April 20, 2026

05.05.2026

9:00–13:00

German

Schreibwerkstatt – Die Dissertation meistern: Vom Gedankenchaos zum gelungenen Manuskript  
Online event  
Registration until April 21, 2026

06.05.2026

9:00–13:15

German

07.05.2026

9:00–13:15

08.05.2026

9:00–13:15

EMF – Application for EU Funding  
In-person event  
Registration until April 27, 2026

12.05.2026

9:30–12:30

English

EMF – Management of Third-Party-Funded Research Projects  
In-person event  
Registration until May 4, 2026

19.05.2026

9:00–17:00

English

20.05.2026

9:00–17:00

# MARA Database

DEUTSCH



## Marburg University Research Academy – Members Area

### Your Registration in the MARA database

In order to use the offers of MARA, please register once in our database with your personal data. Please fill out the form as completely as possible. Note that the fields marked with (\*) are mandatory.

#### Formular

##### Personal information

Title

First name (\*)

Surname (\*)

E-mail (preferred) (\*)

Gender (\*)

- Male  
 Female  
 Divers

What is your nationality?

- German  
 Other

We use this information to specifically address international members

## Registration in the MARA database

- Use our services
- Get information on events and funding opportunities via e-mail distribution list

<https://www.tzm-marburg.de/mara-registrierung/antrag.cfm?lang=en>

# Program for Doctoral Candidates

**Non-academic career**

**Academic career**

**Completion of doctorate**

**Support during doctorate**

**Preparation for doctoral studies**

**Contact** Dr. Karin Awe [karin.awe@uni-marburg.de](mailto:karin.awe@uni-marburg.de)

# Program for Doctoral Candidates – Writing Lab

## Academic writing workshops tailored to the Humanities and Social Sciences & Life and Natural Sciences

### ➤ Writing module

- Writing your dissertation step by step
- Half-day workshops
- English academic writing
- Online writing retreat
- Exposé

### ➤ Publishing module

- Publication process
- Open access
- Writing English-language publications

### ➤ Individual writing consultation ([University Library](#))

# Program for Doctoral Candidates – Open Science

Open Science means more than just free access to publications: It stands for openness, transparency and reproducibility throughout the entire research process.

- Introduction to Research Data Management
- Statistical Data Analysis with R and Python
- Publishing Open Access
- Digital Humanities

[www.uni-marburg.de/de/mara/veranstaltungen/programme-und-zertifikate/open-science](http://www.uni-marburg.de/de/mara/veranstaltungen/programme-und-zertifikate/open-science)

[www.uni-marburg.de/de/forschung/kontakt/eresearch/open-science](http://www.uni-marburg.de/de/forschung/kontakt/eresearch/open-science)

# Workshops for international doctoral candidates and postdocs

- Proportion of English-language events: 44 %
- Events specifically designed for doctoral candidates and postdocs from abroad:
  - [How to Get into the Non-Academic German Job Market! – A Workshop for International Doctoral Candidates and Postdocs](#) (June 11 and 12, 2026)
  - [Finding Your Way at Philipps-Universität Marburg! – How to Settle in, Feel at Home and Thrive at Work](#) (December 3 and 4, 2026)

# Program for Postdocs



## Certificate program EMF

Acquisition of competences for the acquisition and implementation of third-party funded projects



## Science Communication

Bringing topics from your research to the public or a broader scientific community



## Career Development for Postdocs

Support on the way to a professorship and in the decision-making process

## Other events

Further competences and career goals

**Contact** Dr. Christine Berger [christine.berger@uni-marburg.de](mailto:christine.berger@uni-marburg.de)

**Certificate program** on the acquisition of competences for the development, application and management of third-party-funded projects

Module 1:  
Project Design  
and Project  
Application



Module 2:  
Project  
Management



Module 3:  
Presentation of  
Third-Party-  
Funded Projects



Module 4:  
Transfer



Joint project with Universität Kassel

**For** doctoral candidates & postdocs (planning of application for funding)

**Costs** Registration fee 200 EUR + ~ 350 EUR for workshops

**Highlight** Reviewers Session & Acquisition of certificate

<https://www.uni-marburg.de/en/mara/emf>

Info events  
in November

# Program Science Communication

## Workshops

- The Basics of Science Communication
- Presenting Science to a (non-)Academic Audience
- Media and Interview Training
- Social Media
- Podcasting

## Coaching



[www.uni-marburg.de/en/mara/wisskomm](http://www.uni-marburg.de/en/mara/wisskomm)

# Career Development for Postdocs

The program supports on the path to a professorship

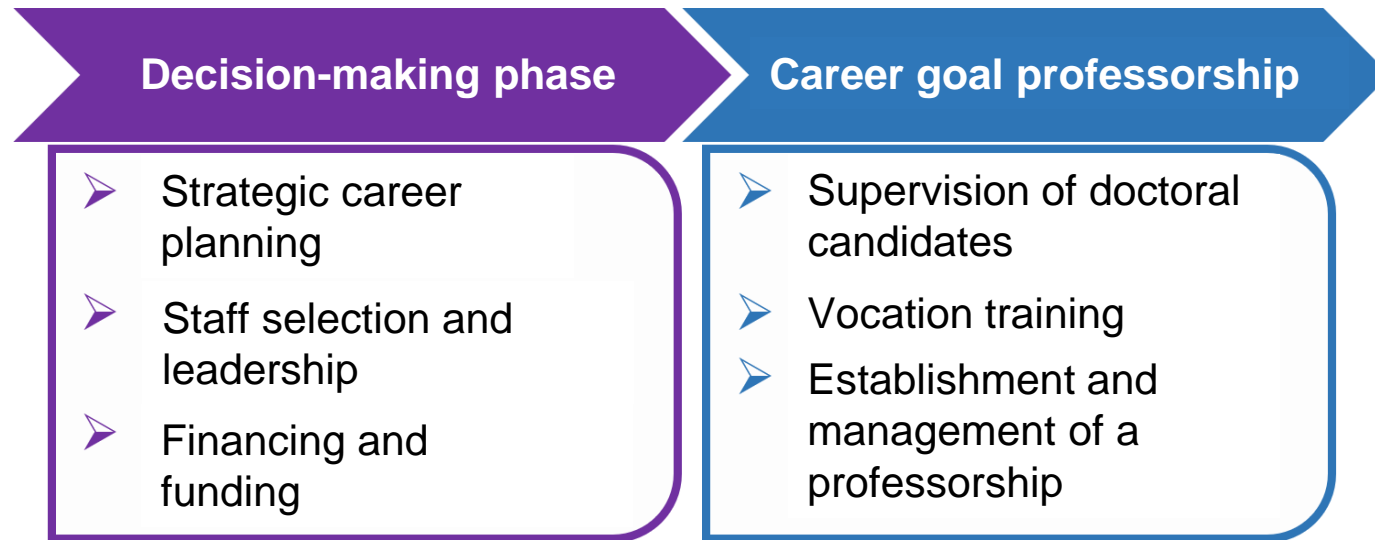

Joint project with Justus-Liebig-Universität Gießen

[www.uni-marburg.de/en/mara/kfp](http://www.uni-marburg.de/en/mara/kfp)

# Program for Postdocs: Further offers



## Workshops on current topics

### Leadership and Management

Academic Fixed-Term Contract Act, Committee Work

### Career Planning and International Issues

Strategic Career Planning

Hidden Job Market

Parenting & Academia

Career in Science Management and Administration

# Funding Opportunities

- Travel Assistance
- Conference Organization
- Completion scholarships
- Equal Opportunity
- Student Assistant-Fund

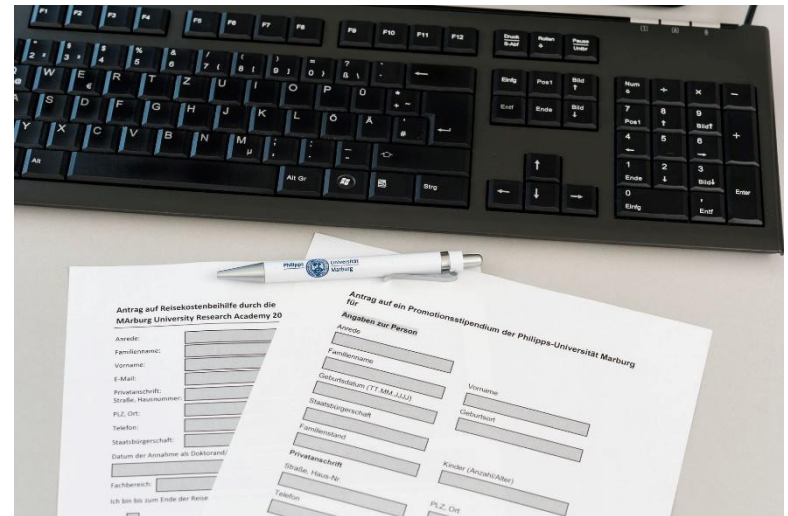

**Contact** Dr. Jan-Paul Klünder  
<https://www.uni-marburg.de/en/mara/funding>

# Travel Assistance for Doctoral Candidates and Postdocs

- Travel expenses/overnight stays/misc. costs
- **No** meal expenses/literature/travel to Germany
- For dissertation/research relevant travel

## International travel

Travel to conferences (only for contributors)  
Travel for academic collaboration with scientists  
Field research (archive, library, monuments, etc.)

## Domestic travel

Travel to national conferences (only if applicant is presenting)  
Travel to international conferences (only if applicant is contributing)  
Field research (archive, library, monuments, etc.)

- **Amount:** Per actual costs, up to 2,000 EUR, 1,500 EUR/trip
- **Timing:** Call for applications usually twice a year

# Conference Organization

- For **organizing conferences** (conference-related costs)
- **No** meal costs, printing costs for publications and internal fees
- Up to **1,500 EUR** + 250 EUR childcare, per actual costs and available funds
- **Requirements:** For the purpose of funding Marburg doctoral candidates and postdocs, public events
- Applications all year, at least **3 months** prior to conference

# Completion scholarships

- Annually for all disciplines
- For particularly qualified academics who are completing their dissertations at the Philipps University of Marburg
- EUR 1,650 + EUR 100 material allowance, EUR 400 child allowance (1st child, additional children EUR 100 each)
- For **max.** 6 months
- Requirement: completion within the funding period, enrollment at a department at Philipps University and performance criteria

# Equal Opportunity

- **Full scholarships** for completion of habilitations (postdocs) for **6 months**
- **Outstanding female junior scholars**  
Postdocs = 2,500 EUR + child allow.
- **Requirements:** Exceptional acad. quality, involvement in UMR, beginning in the current year
- **Applications possible all year round**

# Student Assistant-Fund

- Philipps University doctoral and postdoctoral students with family responsibilities are eligible to apply **to finance a student assistant.**
- The support of a student assistant is funded at **20 hours per month for a maximum term of 6 months.**
- **Requirements:** doctoral candidates and postdocs with time-limited employment contracts and no own personnel funds + family obligations.
- Application deadline expected to be **late November 2026**

# Consultation Services

- Individual consultation
- Coaching
- Peer consultation



## Contact

[www.uni-marburg.de/en/mara/consultation-services](http://www.uni-marburg.de/en/mara/consultation-services)

# Individual Consultation

Personal one-on-one consultation on various subjects:

- Doctorate, yes or no?
- Financing your doctorate/postdoc phase
- MARA funding
- Career paths
- Skill acquisition
- Challenges and conflicts

## Contact

Doctoral candidates (GSW)

Dr. Ines Braune

Doctoral candidates (LNW)

Dr. Karin Awe

Postdocs

Dr. Christine Berger, Dr. Ines Braune

MARA funding

Dr. Jan-Paul Klünder

[www.uni-marburg.de/en/mara/consultation-services/individual-consultation](http://www.uni-marburg.de/en/mara/consultation-services/individual-consultation)

# Coaching

Coaching for advanced doctoral students and postdocs at Philipps University of Marburg, preferably in combination with attendance at a MARA workshop, particularly on the following topics:

- Career planning
- Review of third-party funding applications
- Scientific communication and
- Conference communication

MARA will cover possible costs.

**Contact:** Dr. Christine Berger

[www.uni-marburg.de/en/mara/consultation-services/coaching](http://www.uni-marburg.de/en/mara/consultation-services/coaching)

# Networking

- Scientists' Day
- PhD and Postdoc Meeting
- Welcome Walk



**Contact** Dr. Ines Braune  
[www.uni-marburg.de/en/mara/networking](http://www.uni-marburg.de/en/mara/networking)

# Scientists' Day

Annual information and networking day for early career researcher

- **2021:** Good Scientific Practice
- **2022:** Communicating Academic Content
- **2023:** Internationalization of career planning
- **2024:** Let AI do your research?!
- **2025:** Creativity and Innovation: Thinking Forward!
- **2026: Time & Timing in Academic Career Planning**  
\*\*\* 16.06.2026\*\*\* 3 pm, Alte Aula (Lahntor 3)

Organized by:

Vice President for Equal Opportunities and Career Development, Prof. Dr. Sabine Pankuweit, Department of Early Stage Researchers and MARA

[www.uni-marburg.de/en/mara/networking](http://www.uni-marburg.de/en/mara/networking)

# PhD and Postdoc Meeting



Annual university-wide information and networking day for early career researcher

- **2022:** Communicating Academic Content
- **2023:** Internationalization of career planning
- **2024:** Use Artificial Intelligence!?
- **2025:** Creativity and Innovation: „Future Skills“
- **2026: Time & Timing in Academic Career Planning**  
\*\*\*November 2026\*\*\*

Organized by:

Vice President for Equal Opportunities and Career Development, Prof. Dr. Sabine Pankuweit, Department of Early Stage Researchers and MARA

[www.uni-marburg.de/en/mara/networking](http://www.uni-marburg.de/en/mara/networking)

# Welcome Walk

New or curious?  
Get to know new people and tips...  
walking in the Lahntal and on the Lahnberge.

[May, 12, 4-6 pm](#)  
[Mensa Lahnberge](#)

\*\*\*European Doctoral Day\*\*\*

- > German and English
- > four times a year, 2 hours
- > Important information
- > Networking



**Doctoral candidates** Regardless of whether you are doing your doctorate with a scholarship, on a state or third-party-funded position, or part-time at Philipps-Universität Marburg, you are entitled to take advantage of the MARA services.

- Required is the registration as a doctoral candidate in [MARVIN](#) and the approval of your self-registration by your department.

**Postdocs** If you are doing postdoctoral research at Philipps-Universität Marburg, then you are automatically a member of MARA.

- You count as a postdoc if you finished your disputation and have an employment contract at Philipps-Universität Marburg.

<https://www.uni-marburg.de/en/mara/institution/membership>

1. Self-registration with MARVIN  
(Registration or enrollment as doctoral candidate)
2. Acceptance as a doctoral student at the department
3. Department confirms registration with MARVIN

You are doing your doctorate at a department! You have rights!

-Promotionsordnung  
*Doctoral Degree Regulations*

-Promotionsausschuss  
*Doctoral Degree Committee*

-Betreuungsvereinbarung  
*Mentoring Agreement*

Der Fachbereichsrat des Fachbereichs Fremdsprachliche Philologien der Philipps-Universität Marburg beschließt gemäß § 50 Abs. 1 HHG in der Fassung vom 05.11.2007 (GVBl. I S. 710) folgende Ordnung:

**Promotionsordnung  
des Fachbereichs Fremdsprachliche Philologien  
der Philipps-Universität Marburg  
vom 02.12.2009**

Inhaltsverzeichnis:

- § 1 Anwendungsbereich und Ziele
- § 2 Promotion und Doktorgrad
- § 3 Promotionsausschuss
- § 4 Prüfungskommission
- § 5 Annahme als Doktorandin oder Doktorand
- § 6 Betreuung der Dissertation
  - \* Die Dissertation
  - \* kumulative Dissertation
  - \* Prüfung der Dissertation und Zulassung zum Promotionsverfahren

# Further Contacts at Philipps-Universität

- Brochure: Why do a Doctorate in Marburg?
- Creative Space
- Representation of Doctoral Candidates
- Further Contact Points

# Brochure

## Brochure: "Why do a Doctorate in Marburg?"

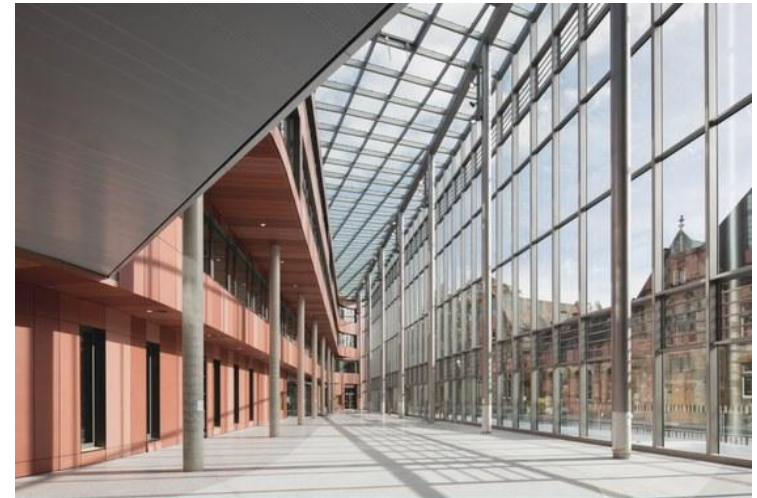

WHY DO  
A DOCTORATE  
IN MARBURG?

# Creative Space – Part of the XSpaces-initiative

The XSpaces are innovative, creative and interconnected workspaces. They support new forms of academic collaboration.

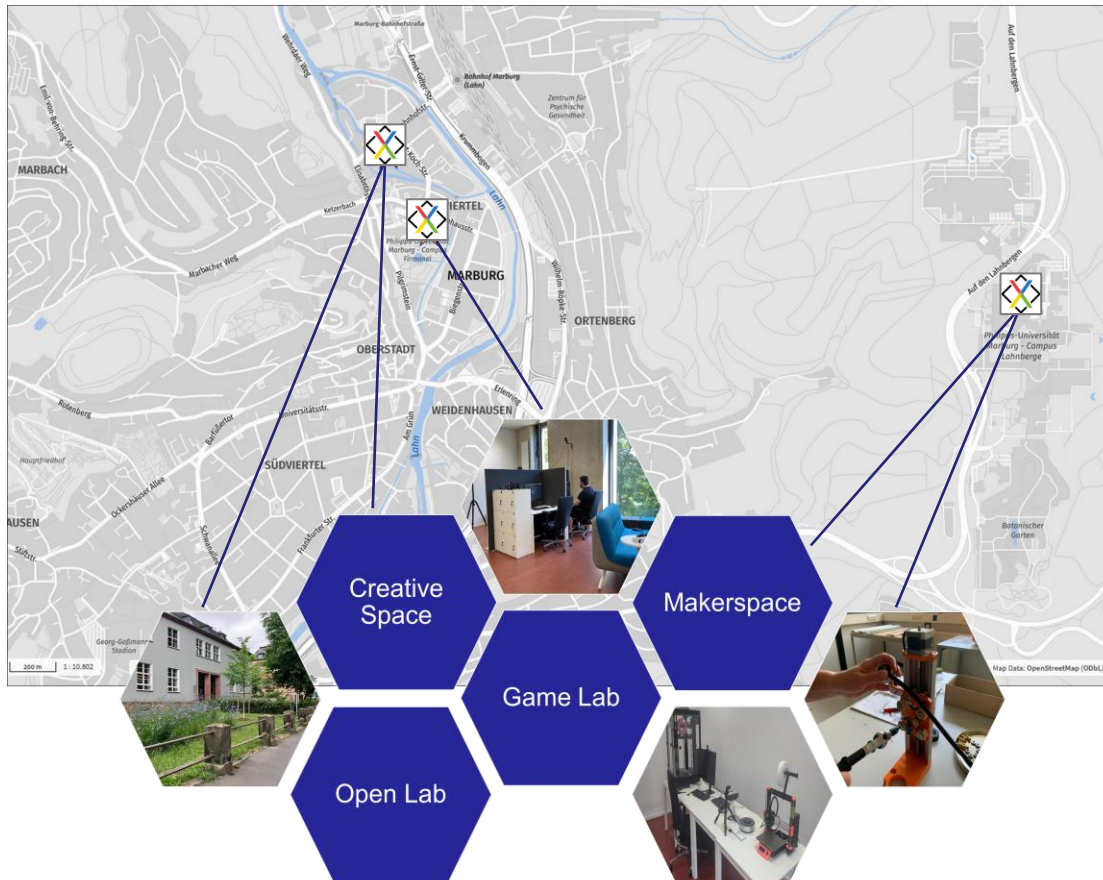

## Makerspace:

The Makerspace is used for teaching and research as well as for start-up promotion. Working with 3-D data and printing is possible, as well as practical work with tools to create prototypes.

email: [makerspace@uni-marburg.de](mailto:makerspace@uni-marburg.de)

## Game Lab:

The Game Lab offers game consoles (PS5, Xbox, Switch) and powerful workstations (Blender, Unity, etc.) as well as a VR area (HTC Vive, Pico Neo 3), augmented reality headsets and a stationary VR treadmill to view computer and video games, virtual reality apps and serious games and evaluate them for use in research and teaching.

email: [medienzentrum@ub.uni-marburg.de](mailto:medienzentrum@ub.uni-marburg.de)

## Open Lab:

In the Open Lab, there is a 3D scanner and 3D printer to make 3D scans of real or illustrative objects, model figures or technical prototypes. Opportunities for collaborative digital work are also offered with the help of an interactive touch display.

email: [medienzentrum@ub.uni-marburg.de](mailto:medienzentrum@ub.uni-marburg.de)

## Creative Space:

The Creative Space provides young academics with a space for creative project development, meetings, workshops, etc. Attractive rooms with flexible furniture and the technical infrastructure for creative collaboration promote new forms of academic collaboration.

email: [creative-space@uni-marburg.de](mailto:creative-space@uni-marburg.de)

Photos (f. l. t. r.):  
View of the Creative Space in Bahnhofstraße (Photo: V. Benthin).  
The Game Lab at the UB (Photo: J. Gaudron).  
The Open Lab at the UB (Photo: M. Meinecke).  
Makerspace: building a cutter (Photo: P. Kuhr).

# What is project Creative Space about?

Establishment of a creative centre for conferences, workshops, project development, network meetings, etc.

Attractive rooms with technical and analogue equipment offer every opportunity for creative collaboration.

Conceptual support through Design Thinking, Lego® Serious Play®, creative project development, advice on event formats

Interdisciplinary meeting place with its own formats such as GameNight.  
Never miss an event? Subscribe to the Game Night mailing list:  
<https://www.lists.uni-marburg.de/lists/sympa/subscribe/gamenight>

## Goals:

- Strengthening the early independence and the individual academic profile of early stage researchers
- Promotion of interdisciplinary cooperation and networking

## Creative Space – Room for ideas



*A place for brainstorming. A space for network meetings, dialogue and project development. A place to get something off the ground together. An event space.*

# Creative Space – „Club Behring“

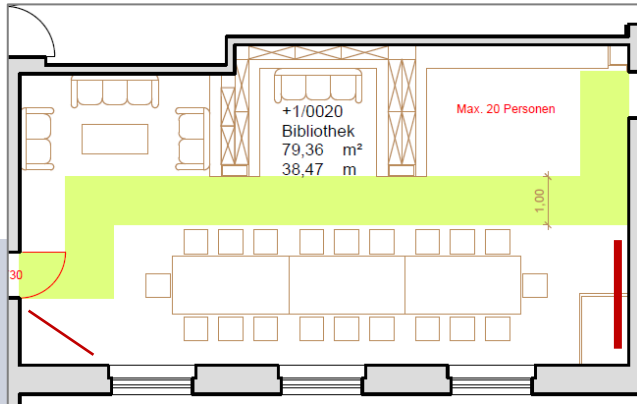

Setting 1: Workshop / Meeting (20 Pers.)

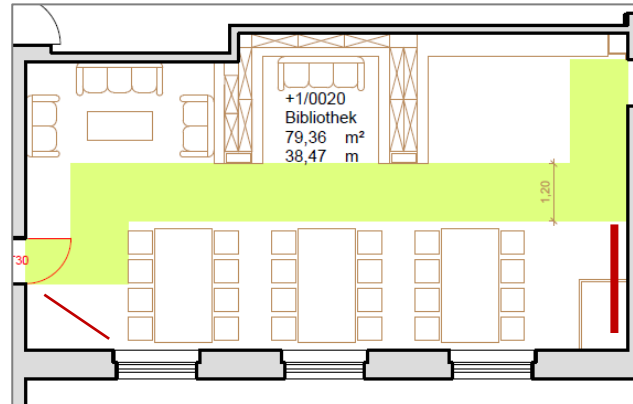

Setting 2: Workshop / 3 „working stations“ (21 Pers.)

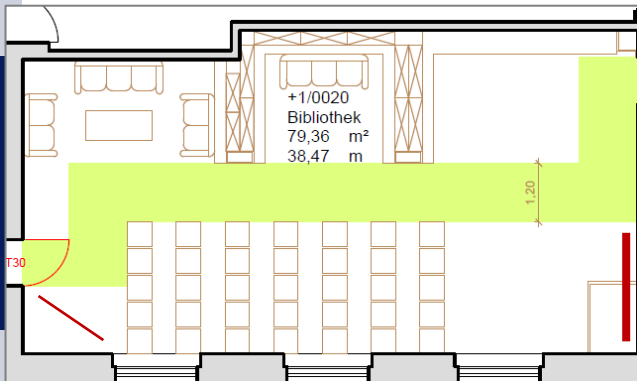

Setting 3: Lecture / Row Seating (35 Pers.)

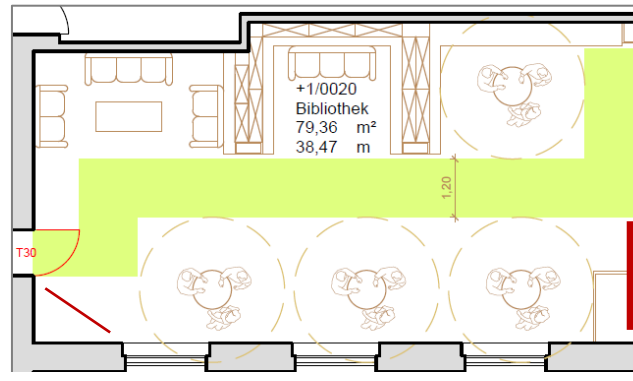

Setting 4: Reception with high tables (50 Pers.)

## Equipment:

- 98" monitor for presentations
- 86" Clevertouch monitor for collaborative editing of documents, as a whiteboard, for hybrid working, video conferencing
- 3 movable work walls as presentation walls, pin boards, memo boards etc.
- Moderation case
- Video conferencing system with camera and table microphones
- Second webcam with integrated microphone and 2 headsets for hosting online events
- Remote control/presenter for presentations
- USB-C adapter, mini display port adapter
- Coffee/tea station

# Creative Space

Website: <https://www.uni-marburg.de/creative-space>

Kontakt: [creative-space@uni-marburg.de](mailto:creative-space@uni-marburg.de)

Booking calendar: <https://buchung-xspaces.uni-marburg.de/en-US/>

## **Follow us on Instagram**

Info, insights, news:

Scan the QR code and follow the Creative Space project:



# Representation of Doctoral Candidates

The elected doctoral candidates' representation of the Philipps-Universität Marburg organizes activities of doctoral candidates at Philipps-Universität Marburg, among others

- Meeting of doctoral candidates
- Regulars' table
- Colloquium
- Readers' meeting
- Dr. Sport

**Email distribution list** and **contact**

[www.uni-marburg.de/de/forschung/talente/promovieren-in-marburg/wir-promovierenden-unter-uns/promovierendenvertretung](http://www.uni-marburg.de/de/forschung/talente/promovieren-in-marburg/wir-promovierenden-unter-uns/promovierendenvertretung)

# Further Interesting Contacts at Philipps-Universität

- [Instruction Development and Teaching in Higher Education](#) (Hochschuldidaktik)
- [International Office](#)
- [Referat für Wissenschaftlichen Nachwuchs](#)
- [Equal Opportunities Office](#)
- [Language Center](#)
- [Human Resource Development](#)  
(Personalentwicklung)



# Next Dates

- [May 12, Welcome Walk, Mensa Lahnberge](#)
- [June 1+2, Introduction to Project Management – Online Event](#)
- [June 16, Scientists' Day](#)
  
- [Visit the Calender of Events](#)



# Thank you for your attention!

## Managing Director

Dr. Ines Braune

[ines.braune@uni-marburg.de](mailto:ines.braune@uni-marburg.de)

## Funding Opportunities

Dr. Jan-Paul Klünder

[jan-paul.kluender@uni-marburg.de](mailto:jan-paul.kluender@uni-marburg.de)

## Program for Doctoral Candidates

Dr. Karin Awe

[karin.awe@uni-marburg.de](mailto:karin.awe@uni-marburg.de)

## Program for Postdocs

Dr. Christine Berger

[christine.berger@uni-marburg.de](mailto:christine.berger@uni-marburg.de)

[www.uni-marburg.de/en/mara](http://www.uni-marburg.de/en/mara)